

**CITY OF LA VISTA
MAYOR AND CITY COUNCIL REPORT
NOVEMBER 6, 2007 AGENDA**

Subject:	Type:	Submitted By:
AMEND SECTION 11.05 OF MUNICIPAL CODE - WARD IV BOUNDARY	RESOLUTION ♦ ORDINANCE RECEIVE/FILE	RITA M. RAMIREZ ASSISTANT CITY ADMINISTRATOR

SYNOPSIS

An ordinance has been prepared to amend Section 11.05 of the La Vista Municipal Code, bringing the legal description of the boundary lines for Ward IV into compliance with recent annexations.

FISCAL IMPACT

None.

RECOMMENDATION

Approval.

BACKGROUND

As areas are annexed and/or platted as part of the City, they are placed into an adjacent election ward. Changes to the legal description of Ward IV boundary lines are needed to bring the Municipal Code into compliance with previous annexations and/or platings approved by the City Council (specifically, Southwind and Val Verde).

ORDINANCE NO. _____

AN ORDINANCE OF THE CITY OF LA VISTA, SARPY COUNTY, NEBRASKA, TO AMEND THE LA VISTA MUNICIPAL CODE SECTION 11.05; TO REPEAL CONFLICTING ORDINANCES PREVIOUSLY ENACTED; TO PROVIDE FOR SEVERABILITY; AND TO PROVIDE FOR THE EFFECTIVE DATE HEREOF.

BE IT ORDAINED BY THE MAYOR AND CITY COUNCIL OF THE CITY OF LA VISTA, SARPY COUNTY, NEBRASKA:

SECTION 1. Section 11.05 of the La Vista Municipal Code is amended to read as follows:

§ 11.05 WARDS.

(A) Ward One is specifically described as follows: Beginning at the intersection of the center line of Harrison Street and the northerly extension of the east line of Lot 113, La Vista Replat; thence westerly on the center line of Harrison Street to a point on the northerly extension of the easterly line of 78th Street; thence southerly on the easterly line of 78th Street and its southerly extension to the southwesterly corner of Lot 880, La Vista; thence southeasterly on the southwesterly lines of Lots 880, 882, 883, 884, and 885, said La Vista to the southeasterly corner of said Lot 885; thence northeasterly on the southeasterly line of said Lot 885 to the southerly line of Park View Boulevard; thence southeasterly on the southerly line of Park View Boulevard to a point on the southwesterly extension of the southerly line of Lillian Avenue; thence easterly on the southerly line of Lillian Avenue to the westerly line of Terry Drive; thence southerly on the westerly line of Terry Drive to the southerly line of Park View Boulevard; thence easterly on the southerly line of Park View Boulevard to the west line of 72nd Street; thence southerly on the west line of 72nd Street to a point on the westerly extension of the north line of Outlot "B", Ardmore; thence easterly on the north lines of Outlot "B" and Lots 70, 71 and 72, Ardmore to the SW corner of Outlot "C", Ardmore; thence northerly on the west line of said Outlot "C" to the NW corner thereof; thence easterly on the north lines of said Outlot "C" and Lot 68, Ardmore to the NE corner thereof; thence northerly on the east line of the NW $\frac{1}{4}$ of the SW $\frac{1}{4}$ of Section 13, T14N, R12E of the 6th P.M. Sarpy County, Nebraska; and on the east line of the west $\frac{1}{2}$ of the NW $\frac{1}{4}$ of said Section 13 to the point of beginning.

(B) Ward Two is specifically described as follows: Beginning at the NE corner of Lot 68, Ardmore; thence southerly on the east lines of Lots 63 through 68, inclusive, Ardmore to the NW corner of Lot 66, Hunter's Creek; thence easterly on the north lines of Lots 66 through 81, inclusive, Hunter's Creek and their easterly extension to the east line of 66th Street; thence southerly on the east line of 66th Street to the center line of Giles Road; thence westerly on the center line of Giles Road to the west line of 72nd Street; thence northerly on the west line of 72nd Street to the SE corner of Lot 1499, La Vista; thence westerly on the south lines of Lots 1493 through 1499, inclusive, and on the south lines of Lots 1472 through 1477, inclusive, and on the south lines of Lots 1481 and 1482, La Vista to the NE corner of Lot 81, Granville East; thence southerly on the east lines of Lots 69 through 81, inclusive, and on the east lines of Lots 65, 66, and 67, and their southerly extension to the center line of Giles Road; thence westerly on the center line of Giles Road to a point on the southerly extension of the west line of Edgewood Boulevard; thence northerly on the west line of Edgewood Boulevard to the SE corner of Lot 901, La Vista; thence northwesterly on the southwesterly lines of Lots 886 through 901, inclusive, La Vista, to the southerly corner of Lot 885, La Vista; thence northeasterly on the southeasterly line of said Lot 885 to the southerly line of Park View Boulevard; thence southeasterly on the southerly line of Park View Boulevard to a point on the southwesterly extension of the southerly line of Lillian Avenue; thence southerly on the westerly line of Terry Drive to the southerly line of Park View Boulevard; thence easterly on the southerly line of Park View Boulevard to the west line of 72nd Street; thence southerly on the west line of 72nd Street to a point on the westerly extension of the north line of Outlot "B", Ardmore; thence easterly on the north lines of Outlot "B" and Lots 70, 71 and 72, Ardmore to the SW corner of Outlot "C", Ardmore; thence northerly on the west line of said Outlot "C" to the NW corner thereof; thence easterly on the north lines of said Outlot "C" and Lot 68, Ardmore to the point of beginning.

(C) Ward Three is specifically described as follows: Beginning at the intersection of the center line of Harrison Street and the northerly extension of the easterly line of 78th Street; thence southerly on the easterly line of 78th Street and its southerly extension to the southwesterly corner of Lot 880, La Vista; thence southeasterly on the southwesterly lines of Lot 880 and Lots 882 through 901, La Vista, to the SE corner of said Lot 901; thence southerly on the west line of Edgewood Boulevard and its southerly extension to the center line of Giles Road; thence westerly on the center line of Giles Road to a point on the southerly extension of the west line of 87th Street; thence northerly on the west line of 87th Street and on the west line of Chinawood Avenue to the northerly line of Honey Locust Drive; thence westerly on the north line of Honey Locust Drive to the SE corner of Lot 62, Park View Heights IV; thence northerly on the

east line of said Lot 62 to the NE corner thereof; thence westerly on the north line of said Lot 62 to the SW corner of Lot 65, Park View Heights IV; thence northerly on the west lines of Lots 65, 66 and 87, Park View Heights IV and their northerly extension to the north line of Granville Parkway; thence easterly on the north line of Granville Parkway to the east line of 88th Street; thence northerly on the east line of 88th Street to the south line of Park View Boulevard; thence easterly on the south line of Park View Boulevard to a point on the southerly extension of the east line of 86th Street; thence northerly on the east line of 86th Street and its southerly extension to the south line of Plaza Boulevard; thence easterly on the south line of Plaza Boulevard and its easterly extension to the centerline of 84th Street; thence northerly on the center line of 84th Street to the center line of Harrison Street; thence easterly on the center line of Harrison Street to the point of beginning.

(D) Ward Four is specifically described as follows: Beginning at the intersection of the center line of Giles Road and the southerly extension of the west line of 87th Street; thence northerly on the west line of 87th Street and on the west line of Chinawood Avenue to the north line of Honey Locust Drive; thence westerly on the north line of Honey Locust Drive to the SE corner of Lot 62, Park View Heights IV; thence northerly on the east line of said Lot 62 to the NE corner thereof; thence westerly on the north line of said Lot 62 to the SW corner of Lot 65, Park View Heights IV; thence northerly on the west lines of Lots 65, 66 and 87, Park View Heights IV and their northerly extension to the north line of Granville Parkway; thence easterly on the north line of Granville Parkway to the east line of 88th Street; thence northerly on the east line of 88th Street to the south line of Park View Boulevard; thence easterly on the south line of Park View Boulevard to a point on the southerly extension of the east line of 86th Street; thence northerly on the east line of 86th Street and its southerly extension to the south line of Plaza Boulevard; thence easterly on the south line of Plaza Boulevard and its easterly extension to the centerline of 84th Street; thence northerly on the centerline of 84th Street to the centerline of Harrison Street; thence westerly on the centerline of Harrison Street to the west line of 96th Street; thence southerly on the west lines of 96th Street to the centerline of Giles Road; thence easterly on the centerline of Giles Road to the point of beginning; together with Outlot "A", Mayfair 2nd Addition, as surveyed, platted and recorded in Sarpy County, Nebraska; together with the SW 1/4 of Section 16, T14N, R12E of the 6th P.M., said Sarpy County; together with that part of the NW1/4 of the SE1/4 of Section 16, T14N, R12E of the 6th P.M., said Sarpy County lying south of the southerly line of the Chicago Burlington & Quincy Railroad; together with that part of the NW1/4 of the SE1/4 of Section 16, T14N, R12E of the 6th P.M., said Sarpy County lying north of the northerly line of the Chicago Burlington & Quincy Railroad; together with that part of the SE 1/4 of Section 16, T14N, R12E of the 6th P.M., Sarpy County, Nebraska, lying south of the north line of Giles Road; together with that part of the NW 1/4 of Section 21, T14N, R12E of the 6th P.M., said Sarpy County, lying north of the south line of Giles Road; together with that part of the NE 1/4 of Section 21, T14N, R12E of the 6th P.M., Sarpy County, Nebraska, lying north of the south line of Giles Road; together with that part of the SE 1/4 of Section 17, T14N, R12E of the 6th P.M., said Sarpy County, lying south of the northerly line of the Union Pacific Railroad and north of the southerly line of Giles Road; together with the right-of-way of the Chicago Burlington & Quincy Railroad lying within the SE 1/4 and within the SW 1/4 of Section 17, T14N, R12E of the 6th P.M., said Sarpy County; together with all that part of the SE 1/4 of Section 17, R14N, R12E of the 6th P.M., said Sarpy County, that lies within the area platted as streets and lots 34 through 46, inclusive, and Outlot "A", Brook Valley Business Park; together with that part of the NE 1/4 of Section 20, T14N, R12E of the 6th P.M., said Sarpy County, lying north of the south line of Giles Road; together with that part of the SW 1/4 of Section 17, R14N, R12E of the 6th P.M., said Sarpy County, lying south of the northerly line of the Union Pacific Railroad and east of the east line of 120th Street and north of the south line of Giles Road; together with that part of the NW 1/4 of Section 20, R14N, R12E of the 6th P.M., said Sarpy County, lying north of the south line of Giles Road; together with all that part of Section 17, T14N, R12E of the 6th P.M., Sarpy County, Nebraska, that lies within the area platted as streets, and lots 1 thru 18, inclusive, and Outlot "A", Harrison Hills; together with lots 1 thru 4, inclusive, and lots 15 thru 27, inclusive, Southport West, a subdivision in said Sarpy County; together with lots 1 thru 3, inclusive, Southport West Replat One a subdivision in said Sarpy County; together with Southport Parkway right-of-way and Westport Parkway right-of-way lying within said Southport West; together with Giles Road right-of-way adjacent to said Southport West on the south; together with 126th Street right-of-way adjacent to said Southport West on the east; together with Lots 1, 5, 6, 14 and 15 and Outlot "A", Southport East, a subdivision in said Sarpy County; together with Lot 10B, Southport East, an administrative subdivision in said Sarpy County; together with Lot 1, Southport East Replat 1, a subdivision in said Sarpy County; together with Lots 1, 2 and 3, Southport East Replat Two, a subdivision in said Sarpy County; together with Lots 1, 2 and 3, Southport East Replat Three, a subdivision in said Sarpy County; together with Lots 1 and 2, Southport East Replat Four, a subdivision in said Sarpy County; together with Lot 11A, Southport East Replat Five, a subdivision in said Sarpy County; together with Southport Parkway right-of-way and Port Grace Boulevard right-of-way lying within said Southport East; together with Giles Road right-of-way adjacent to said Southport East on the south; together with 120th Street right-of-way and 120th Street (relocated) right-of-way adjacent to said Southport East on the east; together with Harrison Street right-of-way adjacent on the south line of Lot 16 said Southport East; together with Lots 1 through 254, and Outlots A, B and C, Val

Verde, a subdivision in said Sarpy County and all public streets lying within said Val Verde; together with Lots 1 through 12 and Outlot A, Val Verde Replat 1, a subdivision in said Sarpy County; together with 96th Street right-of-way and Giles Road right-of-way adjoining said Val Verde, except the east 33 feet thereof; all right-of-ways referenced herein are as they existed on July 29, 2005.

SECTION 2. Repeal of Conflicting Ordinances. All ordinances and parts of ordinances as previously enacted that are in conflict with this Ordinance or any part hereof are hereby repealed.

SECTION 3. Severability. If any section, subsection, sentence, clause or phrase of this Ordinance is, for any reason, held to be unconstitutional or invalid, such unconstitutionality or invalidity shall not affect the validity or constitutionality of the remaining portions of this Ordinance. The Mayor and City Council of the City of La Vista hereby declare that it would have passed this Ordinance and each section, subsection, sentence, clause or phrase thereof, irrespective of the fact that any one or more sections, subsections, sentences, clauses or phrases be declared unconstitutional or invalid.

SECTION 4. Effective Date. This Ordinance shall be in full force and effect from and after passage, approval and publication in pamphlet form as provided by law.

PASSED AND APPROVED THIS 6TH DAY OF NOVEMBER 2007.

CITY OF LA VISTA

Douglas Kindig, Mayor

ATTEST:

Pamela A. Buethe, CMC
City Clerk

City of La Vista

Voting Wards

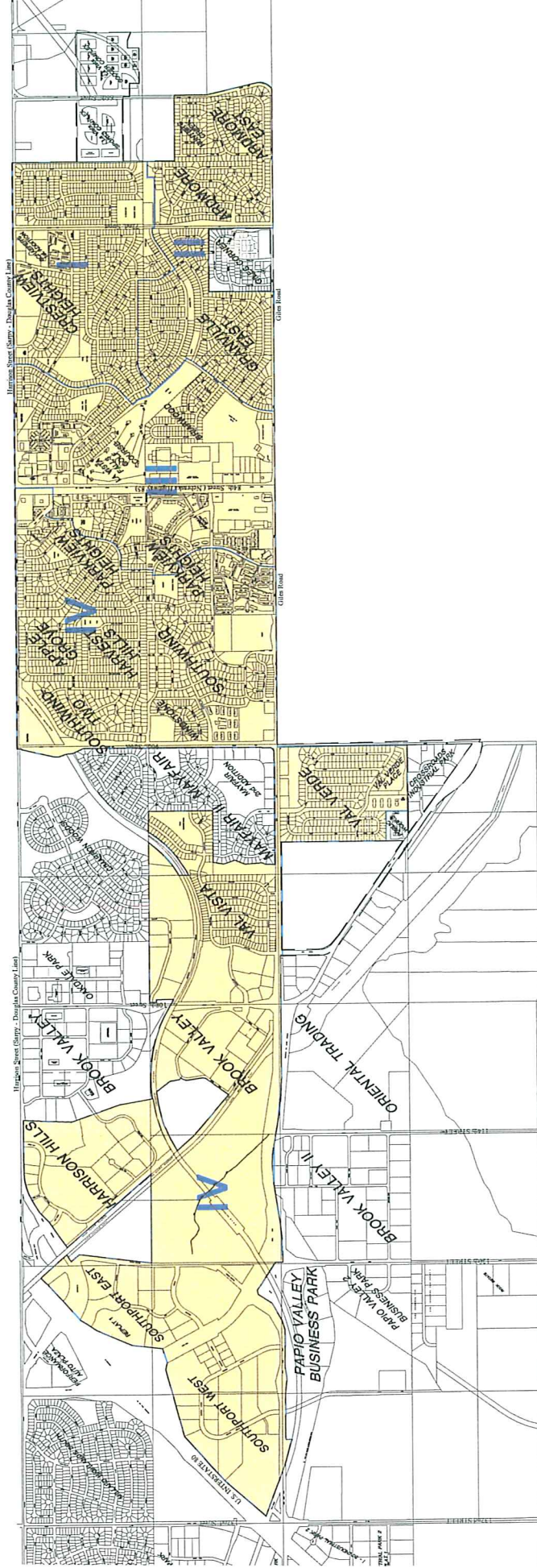

2 THOMPSON, DREESSEN & DORNER, INC.
 Consulting Engineers & Land Surveyors
 10836 OLD MILL ROAD OMAHA, NEBRASKA 68154
 PHONE: 402.330.8860 FAX: 402.330.5866 EMAIL: TD2MAIL@TD2CO.COM
 WEBSITE: WWW.TD2CO.COM

City of La Vista

Voting Ward IV

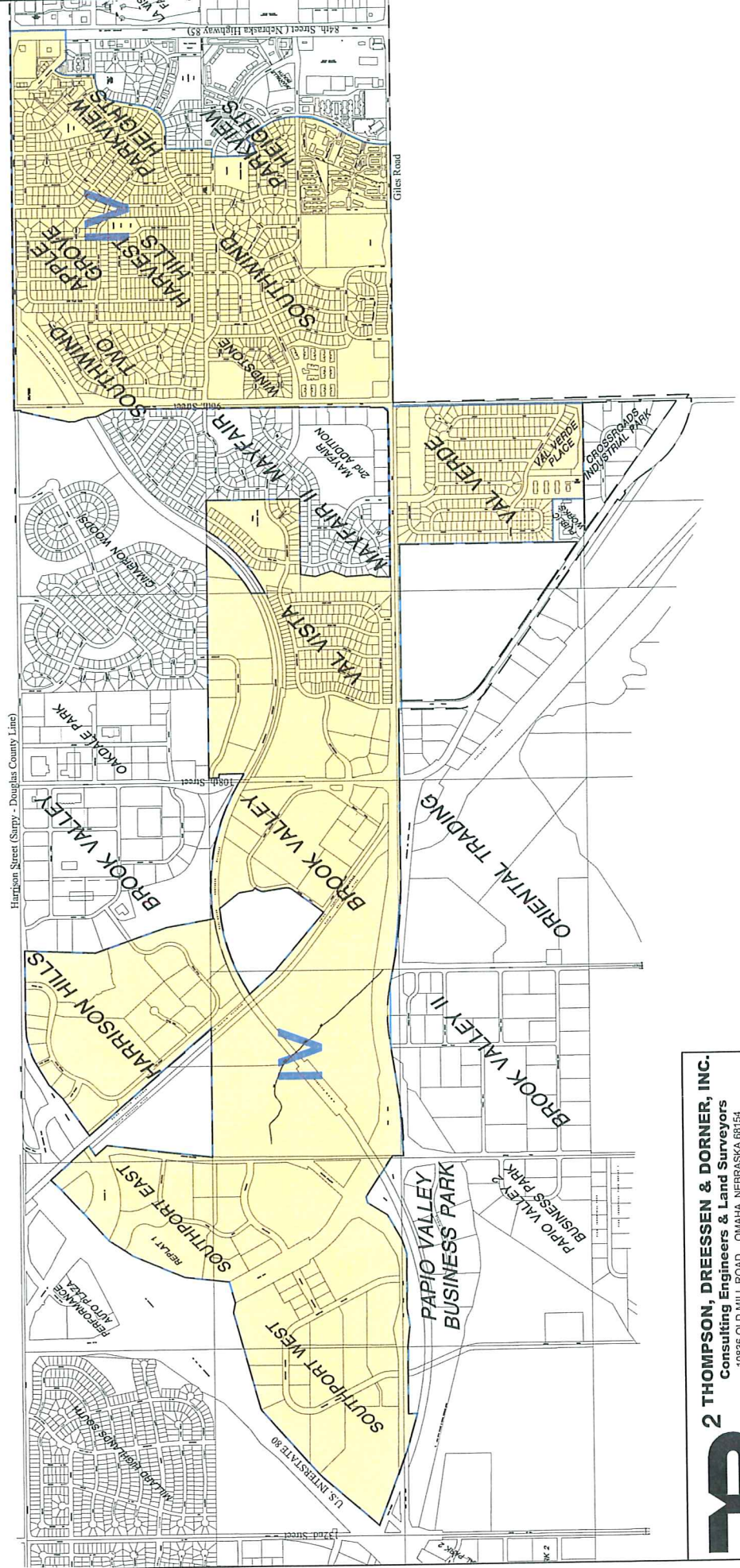



2 THOMPSON, DREESSEN & DORNER, INC.
 Consulting Engineers & Land Surveyors
 10836 OLD MILL ROAD OMAHA, NEBRASKA 68154
 PHONE: 402.330.8860 FAX: 402.330.5666 EMAIL: TD2MAIL@TD2CO.COM
 WEBSITE: WWW.TD2CO.COM

DATE: OCTOBER 2007

lav-voting.dwg